

【Maintenance certificate】

1. Please keep this certificate, and maintenance
2. The witness without agent, will not have signed warranty
3. Not fill in all the 3 packets of prooves and receipt, please invalid to purchase confirmation voucher, 3 packets of prooves and accurate information is correct, and agents, so that we can provide service for you.
4. This certificate if you lost no replacement.

repaired

model	
number	
date	
contact	
zip	
Tel:	
fax	

Maintenance records

Service date	records	Service name

Multi-function Intelligent Metal Detection door



Before installation, please read the instructions carefully and maintained for future reference

contents

note	2
Product description	3
interference	4
Performance and characteristics	4
Components	6
Installation instructions	7
Face instructions	11
Remote instructions	11
Location	12
LCD display instructions	13
Operating procedures	14
Object detection	19
Technical parameters	20
factory parameters	21
After-sales service	22
Maintenance certificate	23

【 After-sales service 】

If this product by our company authorized personnel to ensure the quality of service, the terms of this company is invalid, the consequences for the maintenance such. If the product function by producers cannot control the external factors, the company due to improper use or negligence of users directly or indirectly in personnel or equipment shall not be liable for any damage.

This product is a month, warranty, lifelong service, remove user worries.

A month replacement: customer in purchasing our products within a month, if you find the quality of products, technology appraisal company (artificial damage except) our company provides replacement.

B One year warranty: users with warranty, can enjoy the company provides year guarantee service for free.

C. Lifelong service: the company has sales service in all parts of the country, to provide consultation, long-term technical training and maintenance, upgrade services.

【factory parameters】

Product name	Walkthrough gate
model	800
number	
Alarm time	1 second
1-6zones Sensitivity	85
Whoel Sensitivity 7zones	middle
adress	1
Sensitivity section	1
lanaguage	Chinese english
Backlight standby time	5mins

【Packing list】

Thank you for purchasing our metal detector. Please check the box and ensure the following items. If there is any omission or damage to the goods, please contact your local sales representative.

Power 8 sets of screw remote certificate

The product specification warning stick manual

【Optional accessories】 Networking:

Network connections ,router router, power network ,software

Please read before operation:

Note

The following safety precautions aims to tell you how to correct operation of the product safety, please read and ensure that you already know, after they began to read this other parts.

1 this product only suitable for indoor use, such as the need to be installed outside, should be attached to such rainproof canopy bask in facilities.

2 within 2 meters around the door should not big metal and strong magnetic field, to avoid interference. If the installation area near the door of the metal, metal detector is the distance between the door and door in 1 meters (according to the size of the doors.

3. Installing place as far as possible from the power and telecommunication cables.

4 probe not installed in high temperature, damp environment.

5 laypeople without authorization the baggage hold down on the electric control box.

6 AnJianMen after startup must be 1 minute to achieve optimal self-inspection.

7. Smooth installation, no vibration on a flat on the ground, with six people through avoid collision.

8. Suggest you install a cord from the ceiling to connect more easily detect metal door power.

9 before installation must distinguish probe (left) and the door plank that line and location signal detector probe into corresponding identifier of the line.

【Product description】



The metal detector using international advanced digital detection technology, specially used for man of metal and alloy hidden objects detecting prevention. Its high security, applicability, high sensitivity, detection range, interference ability is strong, can 24 hours service, can also intelligent acousto-optic alarm, in effect, the quality, technical parameters of the world advanced level. Can adjust sensitivity, the highest can be detected and the size of the metal, paper clip can distinguish metal, users still Tibetan bits can be detected according to the size of the metal, volume, weight etc, to exclude COINS, key, jewelry, etc, and private house to prevent dangerous metal articles carried the place, such as the airport, customs, prison, exhibition hall, install the metal detector digital goalkeeper is your wise choice!

【Technical specifications】

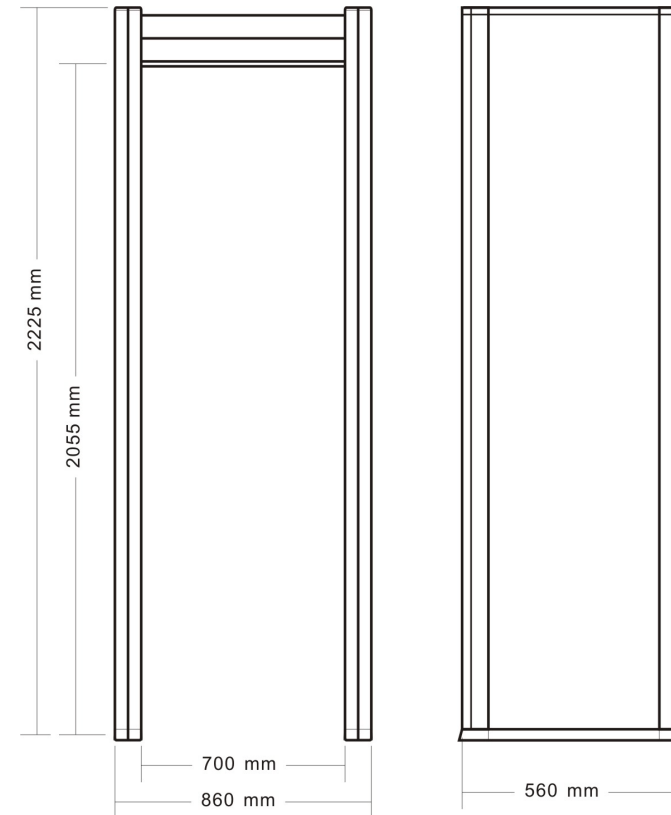

power: AC100V~240V/47HZ~63HZ

net weight: 80kg

Power consumption: < 30W

Temperature: 0°C~+45°C

Alarm: Visual sound alarm

Sensitivity adjustment: 0~99

Tunnel size: 227*23*67cm

face size: 78*49*30cm

【Object detection】

How to eliminate small metal detection larger metal:

On personal carries a metal products to check, we don't want to detect those small metal items such as ring, such as the key, and to detect the larger, can according to the metal, the method to adjust:

1, choose a small metal as samples, this is our sample to detect objects, such as a bunch of keys boundaries.

2, the sensitivity adjustable high, let AnJianMen samples by metal and alarm.

3 and the appropriate sensitivity, again let down by detecting samples. If you still have the alarm, again reducing sensitivity, until the samples by just not alarm sound.

Please remember: as in an area to reduce sensitivity, just adjust the corresponding location, If the door to reduce sensitivity, will adjust the first seven location. (i.e. whole sensitivity adjustment) after the adjustment of the metal will not less than samples of the samples than police all the metal objects can be detected accurately and correctly.

When is check out by gate alarm, he has hiddenMetal objects, if want to determine the exact location of the metal objects and put it out, you can also order the company produced by hand-held metal detectors.

【interference】

metal detector at work of various interferences, mainly by following several:

Electronic interference:

Metal detector for the working frequency 7kHz kHz - 9, use environment should be excluded as generators, around the working frequency of television near electronic products.

Mobile metal objects interfere with:

Metal detector will be moving objects, use metal revolving around the environment should be avoided, large traffic moving metal objects.

Interference between the products and products

Use two or more products, should avoid product crystal frequency (product crystal frequency seen cases). The minimum distance between two TaiMen should keep in 700mm above the door, in order to avoid interference between each other..

【Performance and characteristics】

- LCD display
Use LCDdisplay (chinese english) step, Easy operation.
- Responding to vibration protection function:

When the door because all sorts of circumstances occur when the vibration, will automatically start shaking

Protect function, prevent omission, material misstatement

- Alarm regional instructions:
- Built-in LED lights, accurate door plank that human body corresponding parts of the height of contraband hiding.
- Many gate networking: Realizing each group and networking 20 TaiMen networked computer, digital control through.
- Exploration areas: Optional 6/8/10 overlapping detection area, according to the distribution of metal objects, location and alarm, accurate judgement of the metal objects.
- Sound to alarm: Alarm sound is high, low, mute, suitable for three different time and the use of different situations.
- Adopts the prohibited item recognition:
Through the voice frequency speed, identify the prohibited item.灵
The sensitivity digital adjustment:For the whole sensitivity of high, medium and low mode. Each location at 0-99 between adjust themselves.
- Adopts anti-interference ability:Using digital and analog combination technology, reduce material misstatement, omission, greatly improving product stability.
- Adopts the password protection:Password protection, using software allows only authorized personnel, safety is higher.
- Responding to easy operation:
Through the remote control and operation panel of metal detector.
Counting statistical functions:
Using high-performance micro processor number and alarm frequency statistics through.
- Responding to product safety.
- Pregnant women can safely, sucking produced by any adverse reaction of human body heart pacemakers and magnetic floppy disks, tapes are without any damage.

- 11、 UP and DOWN into "restore Settings" in this factory can restore all the parameters set factory (if more connected to the Internet, will appear frequency interference and the communication address repeat. Therefore restore values, frequency and factory address reduction)

<p>Determine the recovery factory value? [yes] - determine confirmed [no] - cancelled</p>

12. and set all parameters, press "ENTER" save Settings, click "ESC" return to work.

<p>Pass counter 0000 Alarm 0000</p>

8、Language setting UP and DOWN, select "language", click "ENTER" into Chinese, English, have two kinds of choices, through digital key words, representing Chinese, switch 1 2 representative in English.

Language setting
Language - english

9、Password change: UP and DOWN to choose "password change" click "ENTER" ENTER, in this can change the password, regulate the number keys to ENTER the password and press the "ENTER" after confirmation.

Password change
New password--****

10、Display setting UP and DOWN, choose "display Settings" in this function can be set by the standby time, LCD digital key adjust the number 1, 2, 1 minute representatives representing 2 minutes and 5 minutes, 3 4 5 representatives represent 10 minutes, 20 minutes, 6, 7 representatives represent 30 minutes for 60 minutes, 8 representative never extinguished.

Display setting
Backlight standby time - 5 minutes

【Components】

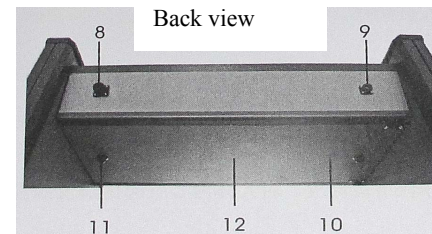
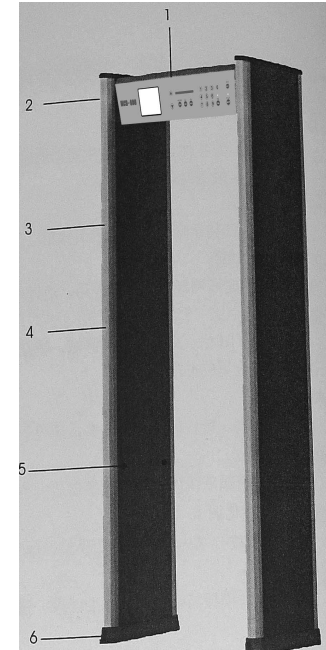

1、mainframe box 2、Standby lamp, 3、alarm (LED) 4、Ethan head 5、Infrared sensors 6、Waterproof feet 7、remotle 8、power connet 9、net connet 10、buzzer 11、main box lock 12、 Mainframe box floor

【Installation instructions】

Please install metal detection in front, read carefully precautions to ensure the products to work, to avoid interference.

1.The plank packing, or from the carried out, then put in foam board. Note or position, left door plank is the use of infrared plug door, right of infrared plug is system 2P line..

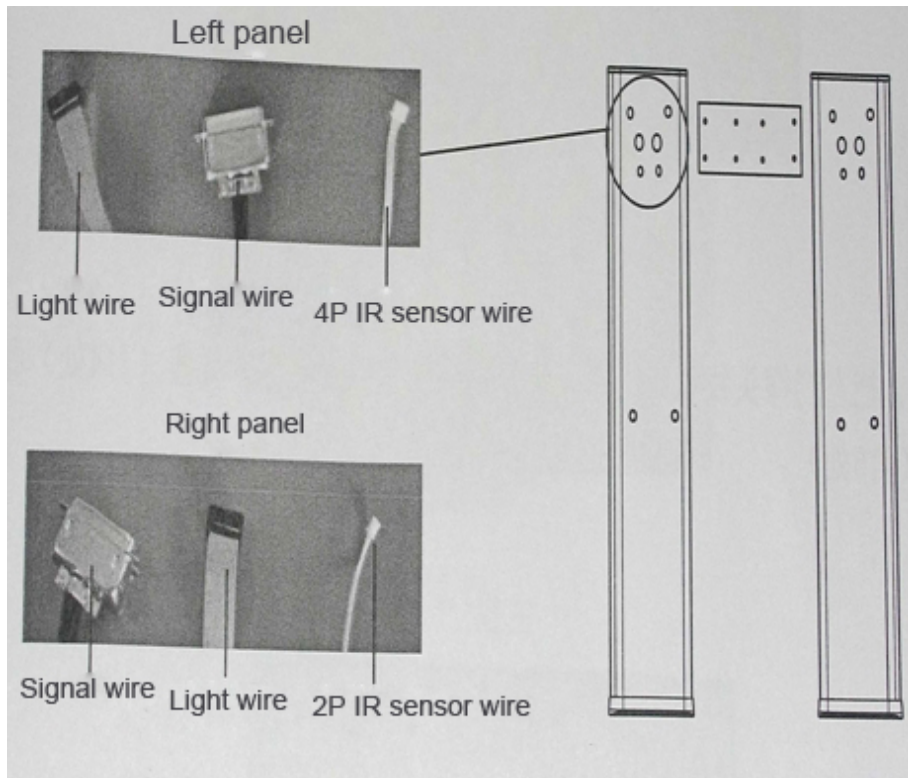

2、 From the mainframe box packing, display panel took place, open the floor mounting screws and mainframe box, fixed.

【Operating procedures】

5、 District sensitivity Settings: UP and DOWN to choose "set" click district sensitivity "ENTER" into "set" and then through the district sensitivity digital key to select the desired location, adjust to changes, the overall sensitivity is sensitivity values is 2, 1, low is 3.

District sensitivity Settings	
1. zones sensitivity	-85
2. zones sensitivity	-85
3. zones sensitivity	-85
4. zones sensitivity	-85
5. zones sensitivity	-85

6、 The communication address Settings: UP and choose "address set DOWN" click "ENTER" can (note: this function only connected with the computer when it effectively).

The communication address Settings	
The communication address - 1	

7、 Band selection: 185 DOWN and choose "band selection" ENTER "set" press ENTER. Eight, through the band can I choose frequency number keys, set according to the "ENTER" after confirmation.

Band selection	
Band selection --1	

【Operating procedures】

- 3、Function: input password set right into the main function, the main function of menu Settings menu contains 8 sub-functions menu (1) in the cursor default.

Function setting	Function setting
1. long alarm Settings	6.Band. Choice
2. each sensitivity Settings	7. Language
3. the communication address Settings	8.The password change Settings
4 band selection	9 the display Settings
5 languages	10.The recovery factory value

4. and alarm set UP and DOWN: long long Settings "choose" alarm, then press ENTER key into "set", through long alarm digital key can be set to 1 seconds duration, 2 seconds or 3 seconds.

Alarm time setting
Alarm time is 1 second

【Installation instructions】

- 3、Left door infrared sensor 4ps line and right infrared system 2P line inserted into the mainframe box control respectively Digital board corresponding socket (J6) and (J7).

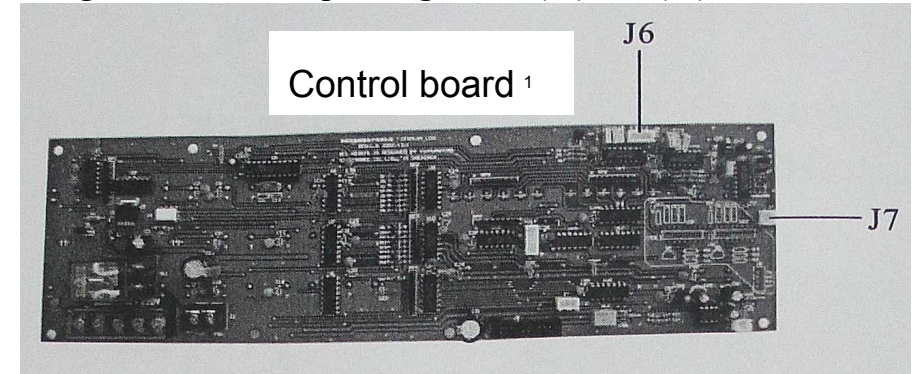

- 4.The left and right door sensor probe into line on the mainboard respectively corresponding socket (J14and J15) and (in).

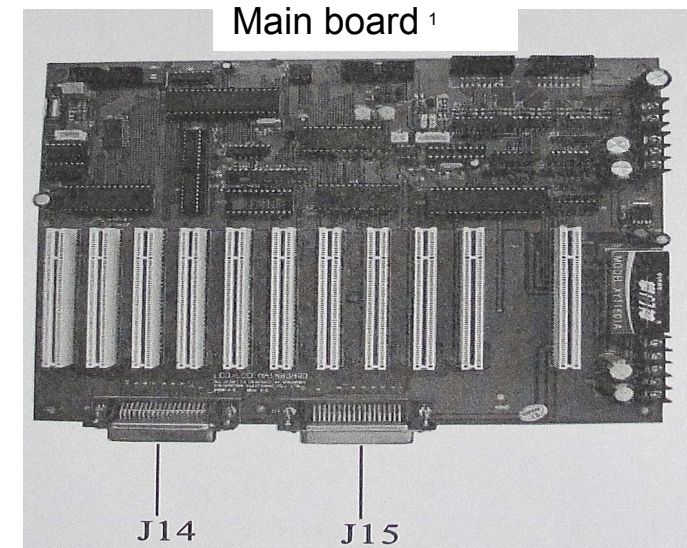

【Installation instructions】

5, will be left lamp door made and right lights were made on the mainboard line plug sockets J7 (corresponding J8 and (in)).

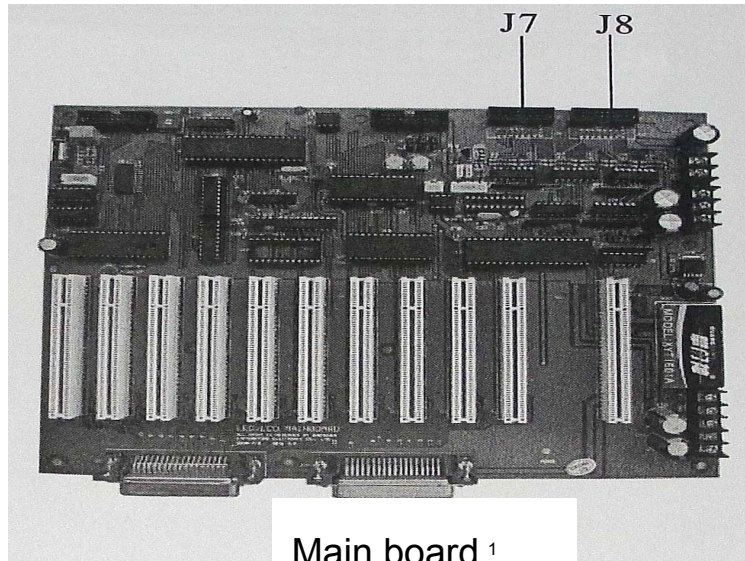

6.then the horn line (horn bottom) installed in the mainframe box from the digital control board corresponding plug (J9), and lock floor..

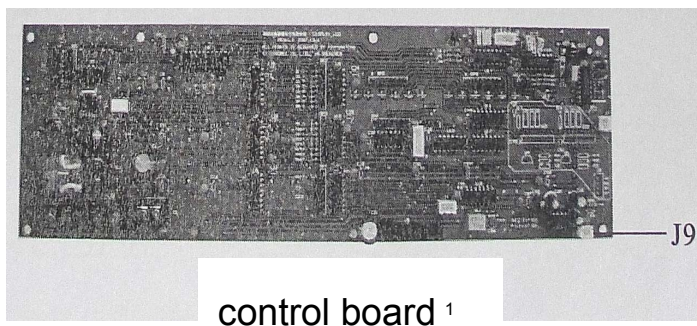

3 and recovery factory Settings: choose this function can make all the parameters AnJianMen recovery factory Settings.

【Operating procedures】

1 and in the menu:

Press "programming (SETUP)" button to enter debug interface, hint, the password is lost in the password when the factory password or operation of the new password.

Input password
password****

1, the input password:

Click "ENTER (confirmed)" button: if the correct password, namely into the main function menu Settings. If you forgot your password, through the keys, where everything lost password "won", and then through the main function menu display Settings "item" password re-enter the new password.

input password
Password mistake According to RenYiJian enter again

【LCD panels】

Function setting
1, the alarm set duration
2, the district sensitivity Settings
3 and the communication address Settings
4 and band selection
5 and language

1、 Password: "1234", the factory password can change the password (see stepsFlash), facilitate the management to prevent illegal operation.

2、 Function main menu: eight sub-functions menu

1.Alarm time Settings: the length of time, the alarm function 1 second, 2 seconds, 3 seconds, can choose. 2.Each set of metals, sensitivity, a AnJianMen induction 6/8/10 there, and every area of sensitivity to shift from 0-99 alone adjustment, the greater the number, the higher sensitivity and six separate area to share a whole sensitivity, overall sensitivity high, middle and low level, adjust overall sensitivity when six separate areas are made corresponding change sensitivity.3.and the communication address set by the communication address: ID 0-99 digital can set different representing different gate in networking, the communication address ID is mainly used for gate connect with computer use, computer AnJianMen for identification .Band selection Settings: eight band can choose, mainly used for more gate workPrevent mutual interference 。 4.language, English set: and chinese 。 5.display Settings: backlight shows standby time, this function has 1, 2, 5, 10, 20, 30 and 60 minutes.

【Installation instructions】

5., the two will be raised to the vertical position TanCeZhan metal, and moved to designated location.

6. and the power plug into the socket (power can 264V 86 - between), through the remote control panel key or open open/shutdown, namely into the standby.

The tooltip.

【Tooltip】

SEC-800 Tooltip

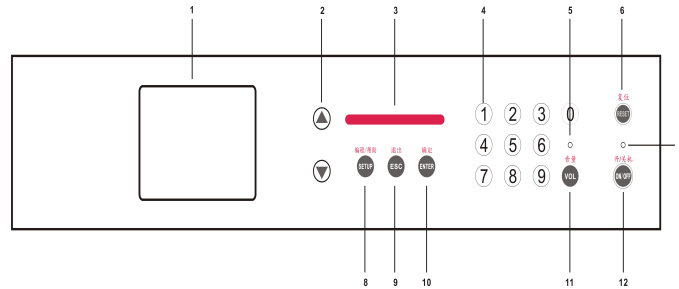

- 1、 liquid crystal display interface: during the commissioning show when parameters in detecting display alarming records and through the number.UP/DOWN 键: 菜单选项。
- 2、 Instructions: 2, weak signal detection to the metal, the greater the size of instructions, signal light lamp。
- 3、 digital key: digital adjustment.
- 4、 and the size of the sound volume indicator: large volume, instructions, and red and green light volume is small volume without instructions。
- 5、 REST key: reset button.
- 6、 power: gate already on detecting state (red), AnJianMen at times (green).
- 7、 SETUP key: programming help。
- 8、 EDC key: quit button.
- 9、 ENTERkey: enter button。
- 10、 VOL key: vol button
- 11、 OFF/NO: on/off button

【Remote control panel】

Remote button operation and panel buttons
Consistent with panel, operating mode



【Location】

A、 standby indicator: it seems be detected in working status, (At around (standby light probe Above 0 Standby lamp light and not respectively Two kinds of state, bright bright green when displayed forColor, standby not light In alarm status (alarm lamp instructions))

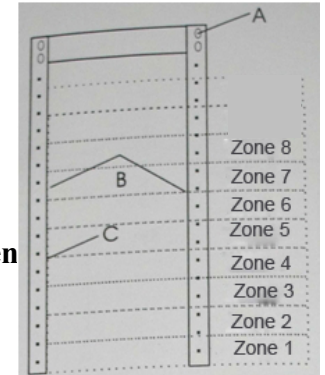

B. alarm location display:

Probe board about six were evenly distributed/eight/ten unique set of accurate positioning lamp, 10 unique set of accurate positioning lights are 8 location, location indicator light is bright and bright state, when the two were detected with inspectors to meet or exceed the set of metal content, then the red alarm indicator, if there are multiple targets, alarm each target location of alarm lamp will light up, also can have alarm sounds (except for mute volume

C., infrared sensors

The power is connected, metal detector began to work, No person or object through the metal detector, Infrared sensors can be effectively stop false-negatives. All metal detectors will be because of its surrounding Some machines and false-negatives, it can be In order to avoid false-negatives, improve and through Through accurate count. When a person When the metal detector, whether any reason The police, the people caused by metal again